



**RoHS
Compliant**



RUT240 LTE Router

Quick start guide v6.0



Front view

- 1 Power LED
- 2 Power socket
- 3 Network type LED
- 4 SIM holder
- 5 Mobile signal strength indication LEDs
- 6 Ethernet ports
- 7 LAN LED
- 8 WAN LED

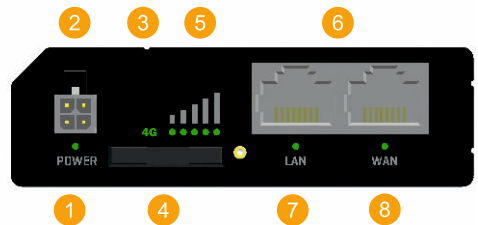

Power socket pinout		
No.	Description	Wire color
1	Power	Red
2	Ground	Black
3	Input	Green
4	Output	White



Back view

- 1 WiFi antenna connector
- 2 Reset button
- 3 LTE antenna connectors

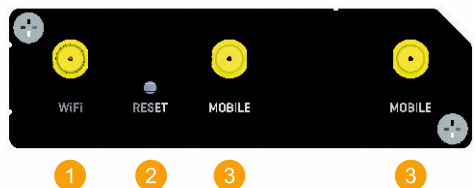

Hardware installation

1. Pull out SIM holder by pushing the button and insert SIM card which was given by your ISP (Internet Service Provider). Correct SIM cards orientation is shown in the picture below.

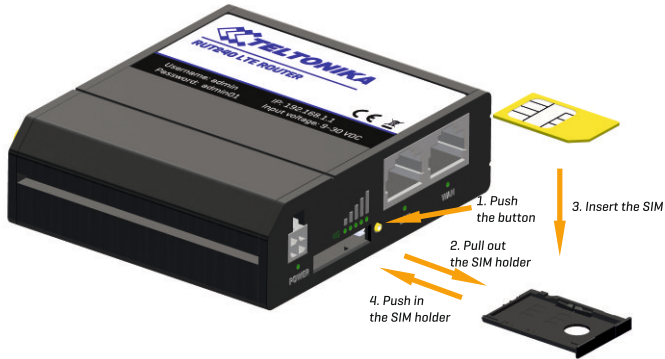

2. Attach LTE antennas.
3. Connect the power adapter to the socket on the front of the device. Then plug the other end of the power adapter into the power socket.
4. Connect to the device wirelessly (SSID: RUT240_001E42 ***** (unique to each device)) or use Ethernet cable and plug into LAN port.

Configure your computer (Windows)

1. Enable the wireless network connection (go to **Start > Control Panel > Network and Internet > Network Connections**. In the left panel click **Change adapter settings** link. Right click on **Wireless Network Connection** and select **Enable**).
2. Setup wireless network adapter on your computer (right click on **Wireless Network Connection** and select **Properties**. After that select **Internet Protocol Version 4 (TCP/IP)** and click **Properties**).
3. Select **Obtain IP address automatically** and **Obtain DNS server address automatically** if they are not selected. Click **OK**.

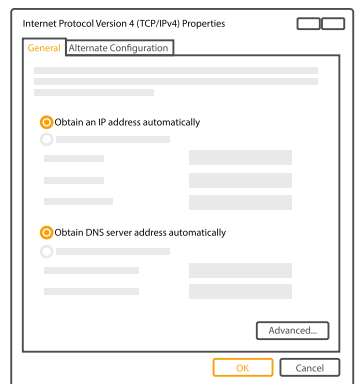
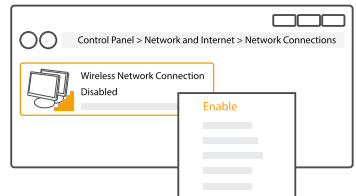

- Right click on [Wireless Network Connection](#) and select [Connect](#) to see available wireless networks.

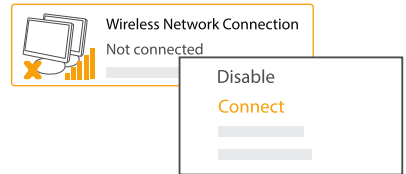

- Choose the wireless network [RUT240_001E42 *****](#) from the list and click [Connect](#).

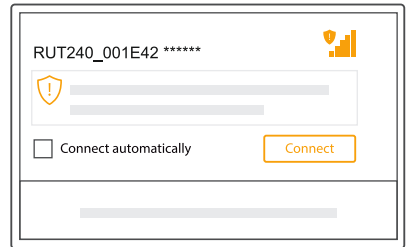

Login to device

- To enter routers Web interface type <http://192.168.1.1> in your internet browser.
- Use the following parameters when prompted for authentication:

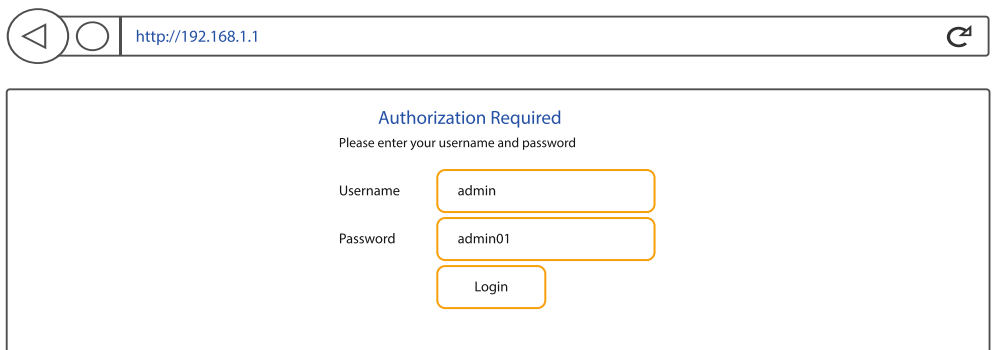

- [Configuration Wizard](#) will start after logging in. It is necessary to complete [Configuration Wizard](#) to setup router to correct mode. You can leave default settings but it is strongly recommended that you change the password and enable [Wireless Security](#).
- Go to [Status > Network information](#) and pay attention to [Signal Strength](#). To maximize the performance try adjusting antennas or changing location of your device to achieve best signal conditions.

Login to device

Mobile	WAN	Wireless	Topology	Access
Mobile Information				
Mobile 				
Data connection state	Connected			
IMEI	868323023148973			
IMSI	246021004265840			
Sim card state	Ready			
Signal strength	-79 dBm			

Safety information

RUT240 router must be used in compliance with any and all applicable national and international laws and with any special restrictions regulating the utilization of the communication module in prescribed applications and environments.

Specifications	
Software	RUT240_R_XX.XX.XXX
Frequency bands*	EEE802.11b/g/n 2400 MHz, GSM/EDGE/3G, UMTS/HSPA+
Max. RF power	20 dBm@WiFi, 33 dBm@GSM/GPRS/EDGE, 24 dBm@UMTS
Representative accessories specifications	
Power	AC/DC power adapter 9 V 1 A, 4 pin plug
GSM/WCDMA/LTE antenna	703-960/1710-1990/2110-2170/2500-2690 MHz, 50 Ω, VSWR ≤ 2, gain** 1 dBi, omnidirectional, SMA connector
WiFi antenna	2401-2462 MHz, 50 Ω, gain** 3 dBi, VSWR ≤ 1.5, omnidirectional, RP-SMA connector

* Supported frequency bands are dependent on geographical location and may not be available in all markets.

** If an extension cable is used to attach the antenna, the antenna gain may be higher by the amount of cable attenuation. The user is responsible for the compliance with the legal regulations.



This sign on the package means that it is necessary to read the Users Manual before you start using the device.



This sign on the package means that all used electronic and electric equipment should not be mixed with general household waste.



Hereby, Teltonika declares that the radio equipment type RUT240 is in compliance with Directives: 2014/53/EU, 2014/35/EU, 2014/30/EU. The full text of the EU declaration of conformity is available at the following internet address: <http://teltonika.lt/product/rut240/>